

BANQUET FLOOR PLAN

If people are more productive in spaces that inspire, then our facilities will deliver impressive results.

Discover historic, inspiring and unique ambience of the Mandarin Oriental, Prague. Combined with 99 rooms and suites, our hotel is a perfect hidden urban hideaway in the heart of Prague. Our Baroque banqueting venues are flooded with daylight and feature magnificent historic features.

BANQUET VENUES SPECIFICATIONS

Room	Theatre	Classroom	Boardroom	U-Shape	Rounds	Cabaret	Reception	Dimensions
Grand Ballroom	160	100	50	50	120	80	150	20.7 x 7.6 m
Dominicus Hall	45	32	18	20	40	32	50	7.6 x 7.6 m
Monastery Lounge	n/a	n/a	n/a	n/a	60	n/a	150	34.7 x 3.4 m
Boardroom 2	n/a	n/a	12	n/a	n/a	n/a	n/a	7.0 x 3.5 m

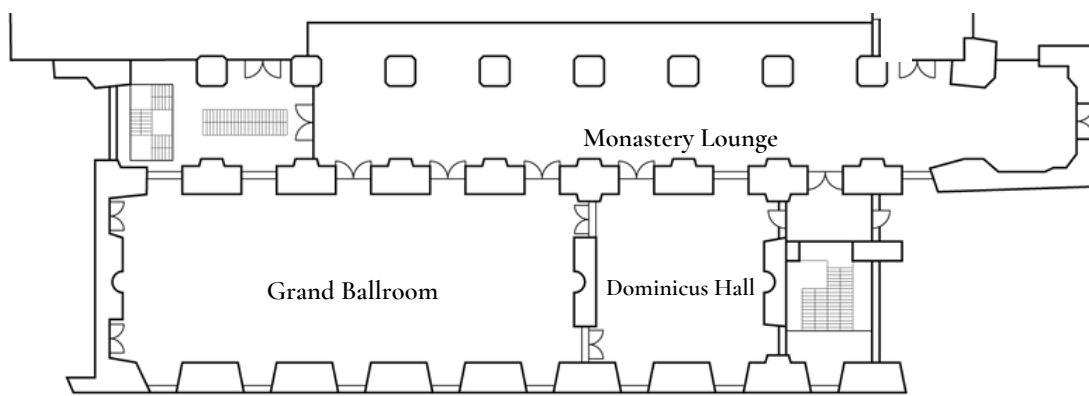

Please note that total venue capacity cannot be calculated by combining individual room capacities, as Monastery Lounge serves as a primary pre-function area and circulation corridor.

For inquiries, please contact:

moprg-sales@mohg.com, +420 233 088 751

Mandarin Oriental, Prague - Neboviđská 459/1 - 11800 Praha 1