

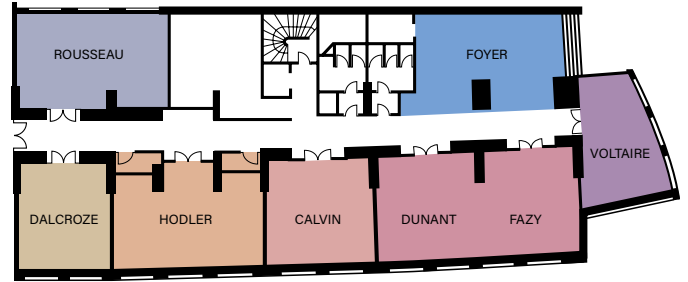

FACILITIES

GROUND FLOOR

1ST FLOOR

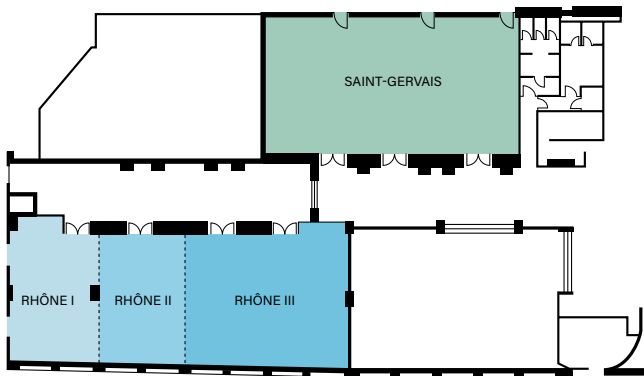

RHÔNE RIVER

CAPACITIES



Function Rooms	Lenght m/ft	Width m/ft	Size sq.m/sq.ft	Height m/ft	Cocktail Reception	Banquet Dinner	Meeting Theatre	Meeting Classroom	Meeting U-Shape	Boardroom	Cabaret
GROUND FLOOR											
Rhône I	10 / 32.8	6.5 / 19.6	65 / 700	2.6 / 8.5	50	40	55	36	27	28/30	28/30
Rhône II	10 / 32.8	6.5 / 19.6	65 / 700	2.6 / 8.5	50	40	55	36	27	28/30	28/30
Rhône III	10 / 32.8	13 / 42.6	130 / 1399	2.6 / 8.5	100	100	100	60	40	30	70
Rhône I - II - III	26.5 / 85.3	10 / 32.8	265 / 2852	2.6 / 8.5	250	230	200	108	50	36/40	114
Saint-Gervais	19.1 / 62.3	10 / 32.8	193 / 2077	3.6 / 11.8	200	160	200	84	50	45	112
1ST FLOOR											
Dalcroze	5.5 / 16.4	6.5 / 19.6	36 / 387	2.6 / 8.5	-	-	-	-	-	12	-
Hodler	4.5 / 13.1	9.5 / 29.5	43 / 462	2.6 / 8.5	35	40	40	24	25	25	28
Calvin	6.5 / 19.6	6.8 / 19.6	44 / 473	2.6 / 8.5	25	30	30	27	18	15	21
Dunant	6 / 19.6	13.6 / 42.6	84 / 904	2.6 / 8.5	30	30	30	27	18	15	21
Fazy	6 / 19.6	13.6 / 42.6	84 / 904	2.6 / 8.5	25	20	20	24	12	12	14
Dunant + Fazy	6 / 19.6	27.2 / 85.2	168 / 1808	2.6 / 8.5	65	60	60	30	30	-	42
Voltaire	4.7 / 13.1	7.8 / 22.9	37 / 398	2.6 / 8.5	-	-	-	-	-	12	-
Rousseau	5 / 16.4	9.5 / 29.5	48 / 516	2.6 / 8.5	35	40	40	24	25	25	28
Foyer	8 / 26.2	9 / 29.5	72 / 775	2.6 / 8.5	50	24	-	-	-	-	-

CONTACT

Mandarin Oriental, Geneva
 Quai Turretini 1, 1201 Geneva, Switzerland
 Telephone +41 (0) 22 909 0099
 E-mail mogva-sales@mohg.com