

# Floor plan

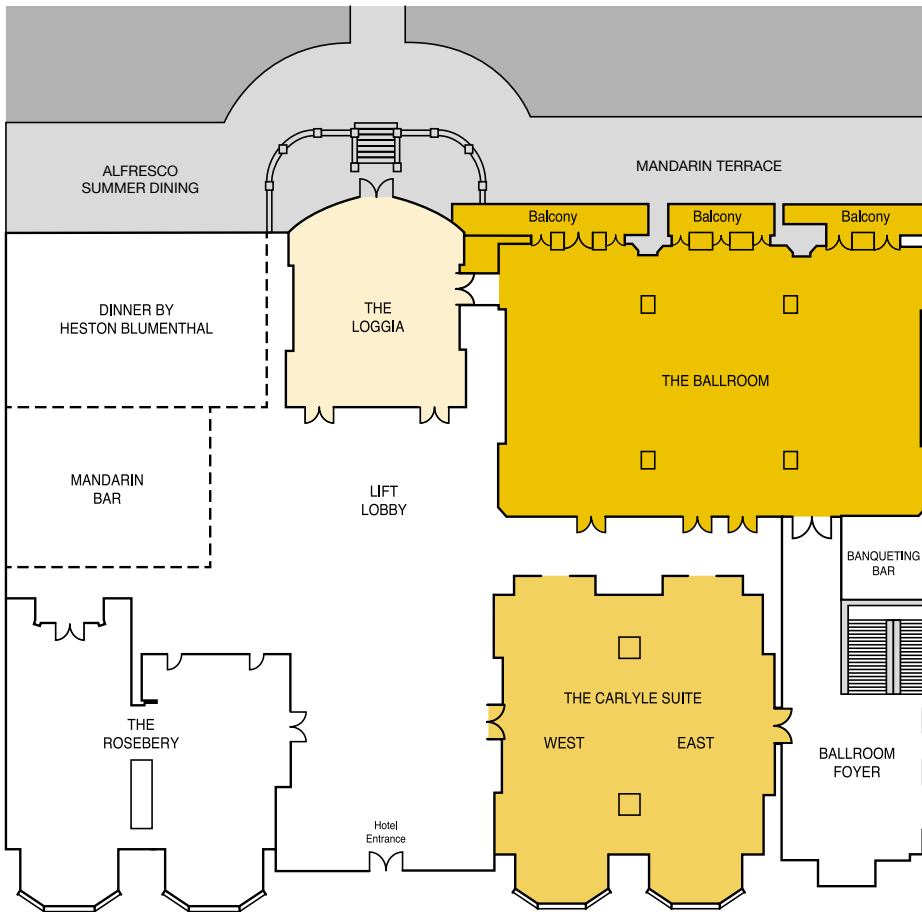

Ground floor

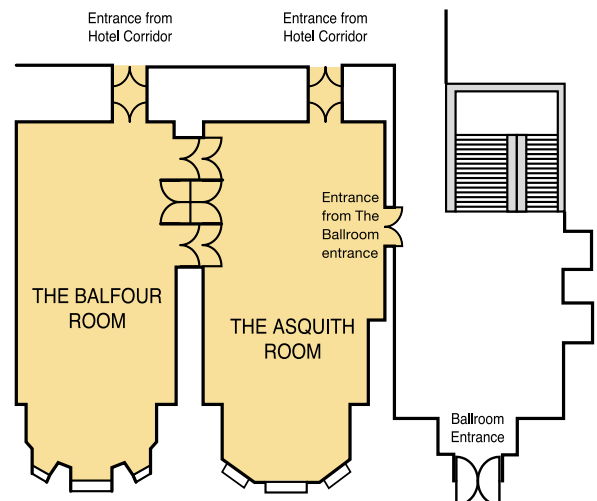

Lower ground floor

# Private dining and meetings



Rooms	Capacities							Dimensions Feet (metres)				
	Theatre	Classroom	Boardroom	U-Shape	Lunch/ Dinner	Dinner Dance	Reception	Length	Width	Area	Height (max)	Height (min)
The Ballroom	250	120	60	70	250	200	400	66'9" (20.36m)	39'4" (12m)	2625 ft <sup>2</sup> (243.87m <sup>2</sup> )	16'3" (4.96m)	8'7" (2.63m)
The Carlyle Suite (Whole)	120	80	40	40	150	70	250	44'11" (13.7m)	46'10" (14.29m)	1979 ft <sup>2</sup> (183.86m <sup>2</sup> )	16'3" (4.96m)	8'2" (2.5m)
The Carlyle Suite (East)	60	40	30	30	70	N/A	120	46'10" (14.29m)	20'3" (6.2m)	828ft <sup>2</sup> (76.92m <sup>2</sup> )	16'3" (4.96m)	8'2" (2.5m)
The Carlyle Suite (West)	60	40	30	30	70	N/A	120	46'10" (14.29m)	19'4" (5.9m)	828ft <sup>2</sup> (76.92m <sup>2</sup> )	16'3" (4.96m)	8'2" (2.5m)
The Balfour Room	40	30	25	20	30	N/A	70	32'3" (9.84m)	19'7" (5.98m)	611ft <sup>2</sup> (56.8m <sup>2</sup> )	8'8" (2.56m)	8'2" (2.5m)
The Asquith Room	40	30	25	20	30	N/A	70	33'9" (10.29m)	22'4" (6.8m)	666ft <sup>2</sup> (61.9m <sup>2</sup> )	8'8" (2.56m)	8'2" (2.5m)
The Loggia	40	N/A	20	15	30	N/A	70	33'2" (10.05m)	27'9" (8.47m)	927ft <sup>2</sup> (85.12m <sup>2</sup> )	16' (4.8m <sup>2</sup> )	11'5" (3.48m <sup>2</sup> )

## Ground Floor: The Ballroom

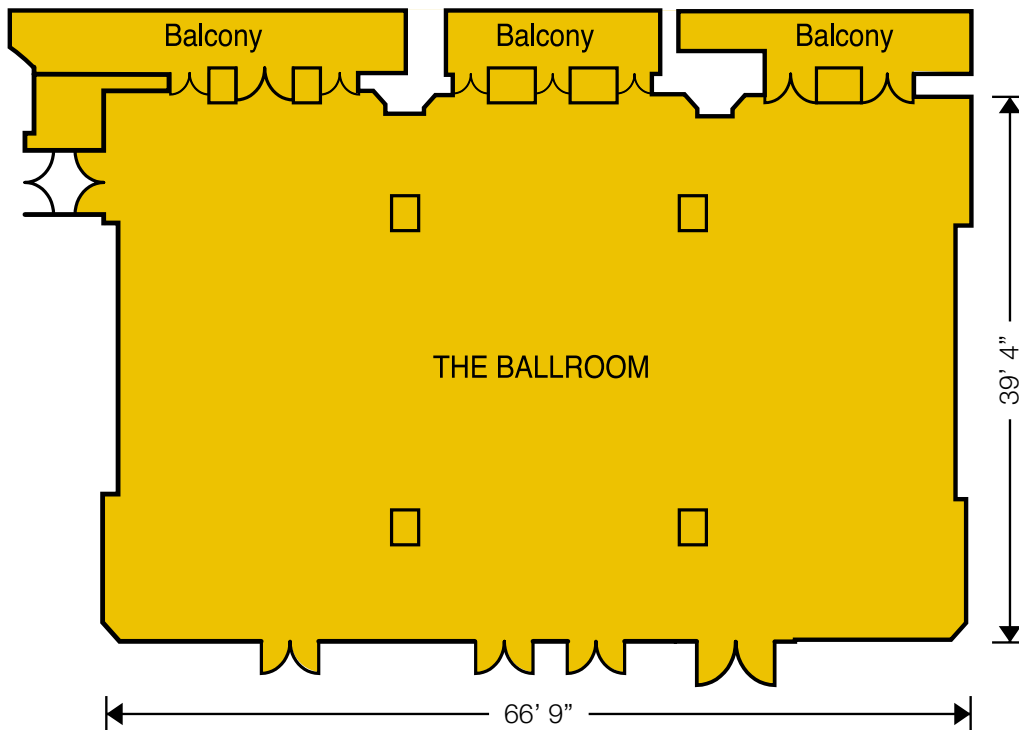

Function Rooms	Dimensions Feet	Square Feet	Square Metres	Theatre	Classroom	Boardroom	U-Shape	Lunch/ Dinner	Dinner Dance	Reception
The Ballroom	66'9"x39'4" H8'7"	2,625ft <sup>2</sup>	243.87m <sup>2</sup>	250	120	60	70	250	200	400

## Ground Floor: The Carlyle Suite

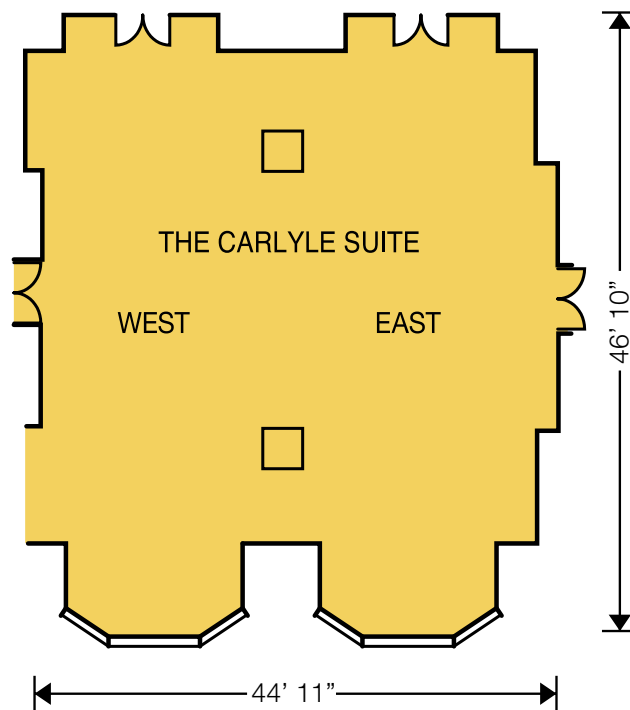

Function Rooms	Dimensions Feet	Square Feet	Square Metres	Theatre	Classroom	Boardroom	U-Shape	Lunch/Dinner	Dinner Dance	Reception
The Carlyle Suite (Whole)	44'11"x46'10" H8'2"	1,979ft <sup>2</sup>	183.86m <sup>2</sup>	120	80	40	40	150	70	250
The Carlyle Suite (East)	46'10"x20'3" H8'2"	828ft <sup>2</sup>	76.92m <sup>2</sup>	60	40	30	30	70	N/A	120
The Carlyle Suite (West)	46'10"x19'4" H8'2"	828ft <sup>2</sup>	76.92m <sup>2</sup>	60	40	30	30	70	N/A	120

## Lower Ground Floor: The Balfour Room

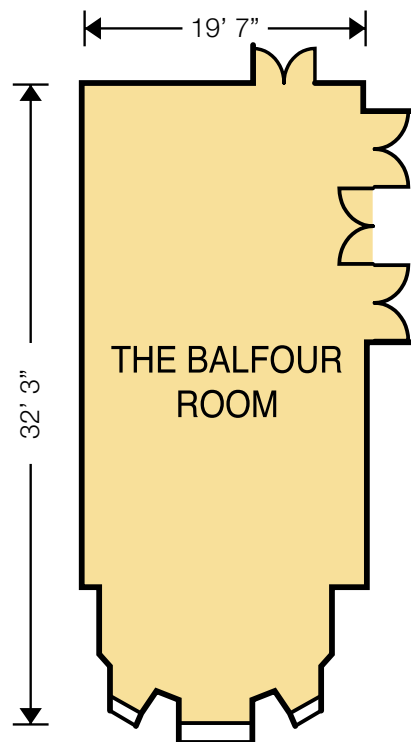

Function Rooms	Dimensions Feet	Square Feet	Square Metres	Theatre	Classroom	Boardroom	U-Shape	Lunch/Dinner	Dinner Dance	Reception
The Balfour Room	32'3"x19'7" H8'2"	611ft <sup>2</sup>	56.8m <sup>2</sup>	40	30	25	20	30	N/A	70

## Lower Ground Floor: The Asquith Room

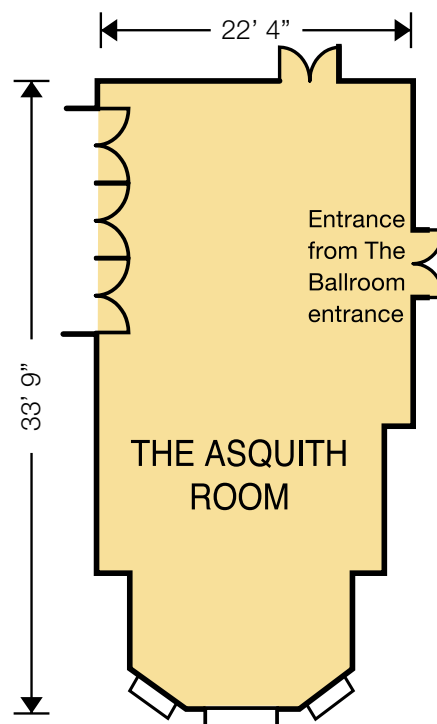

Function Rooms	Dimensions Feet	Square Feet	Square Metres	Theatre	Classroom	Boardroom	U-Shape	Lunch/Dinner	Dinner Dance	Reception
The Asquith Room	33'9"x22'4" H8'2"	666ft <sup>2</sup>	61.9m <sup>2</sup>	40	30	25	20	30	N/A	70

## Ground Floor: The Loggia

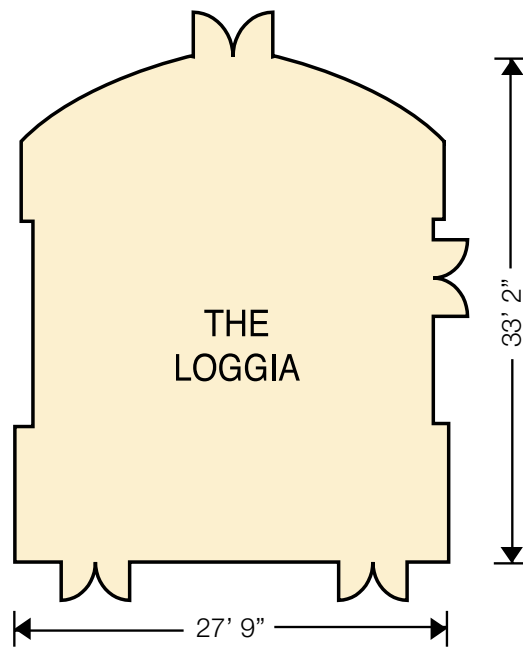

Function Rooms	Dimensions Feet	Square Feet	Square Metres	Theatre	Classroom	Boardroom	U-Shape	Lunch/Dinner	Dinner Dance	Reception
The Loggia	33'2"x27'9" H11'5"	927ft <sup>2</sup>	85.12m <sup>2</sup>	40	N/A	20	15	30	N/A	70